

RPMGLOBAL

ASSET MANAGEMENT MASTERCLASS

21st August 2024 | The Langham, Jakarta

- EVENT AGENDA -

Unlocking Efficiency and Sustainability with
AMT: Your Dynamic Lifecycle Costing Solution

Asset Management Strategies

Exclusive Product Insights

Networking Opportunities

Welcome

Welcome to RPMGlobal's Asset Management Masterclass, with this year's theme, Unlocking Efficiency and Sustainability with AMT: Your Dynamic Lifecycle Costing Solution. We're thrilled to have you with us for a day of engaging and informative sessions led by our team of asset management and software experts.

Together, we will dive into a range of Asset Management and Inventory Optimisation topics, focusing on strategies to elevate efficiency across all stages of your mining operations. Additionally, we'll explore our comprehensive Software Suite, demonstrating how it can drive transformative results for your business.

Site Map

Please find our Registration Desk, Experience Centre, and Networking/ Breakout areas on Level 2.

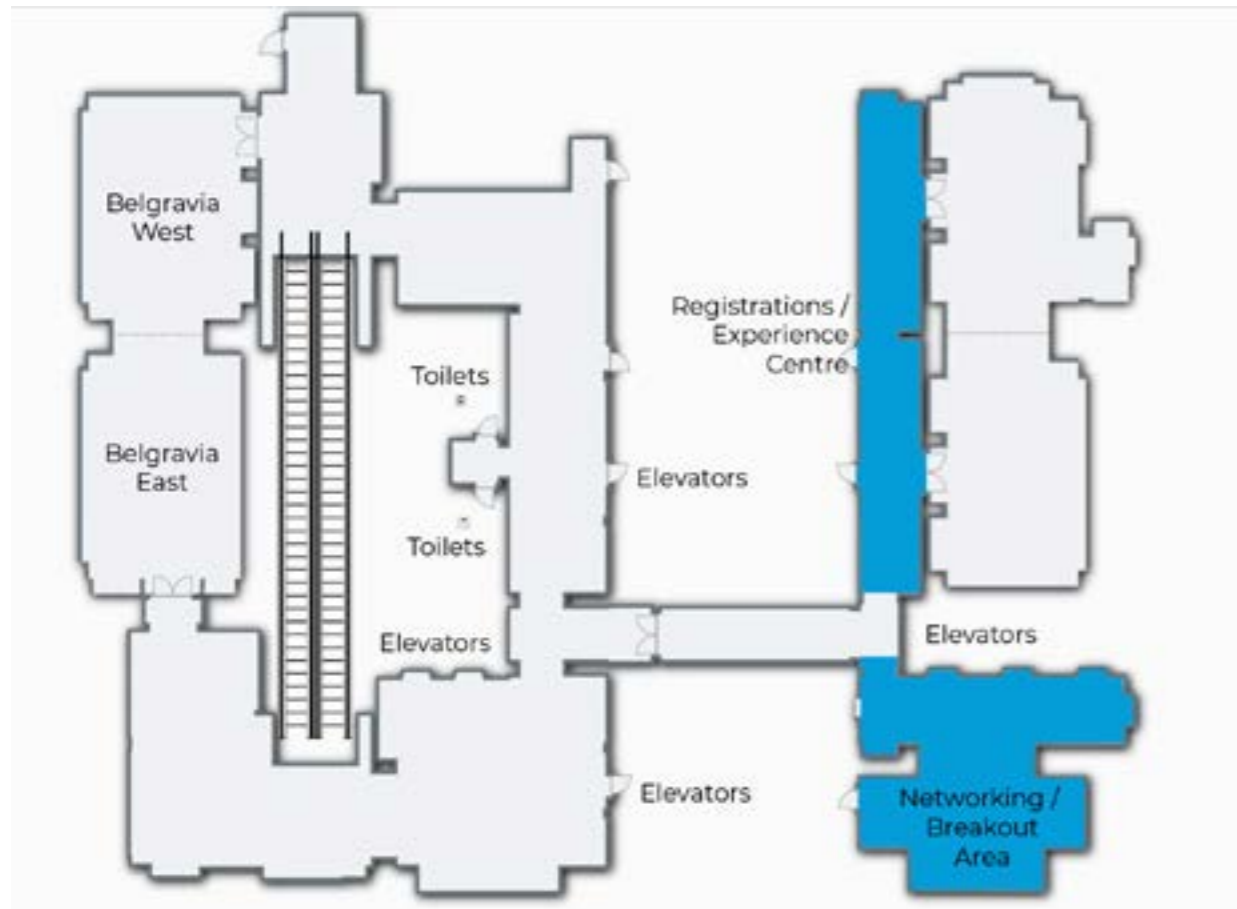

The Asset Management Masterclass is located on Level 5 in the Richmond Room.

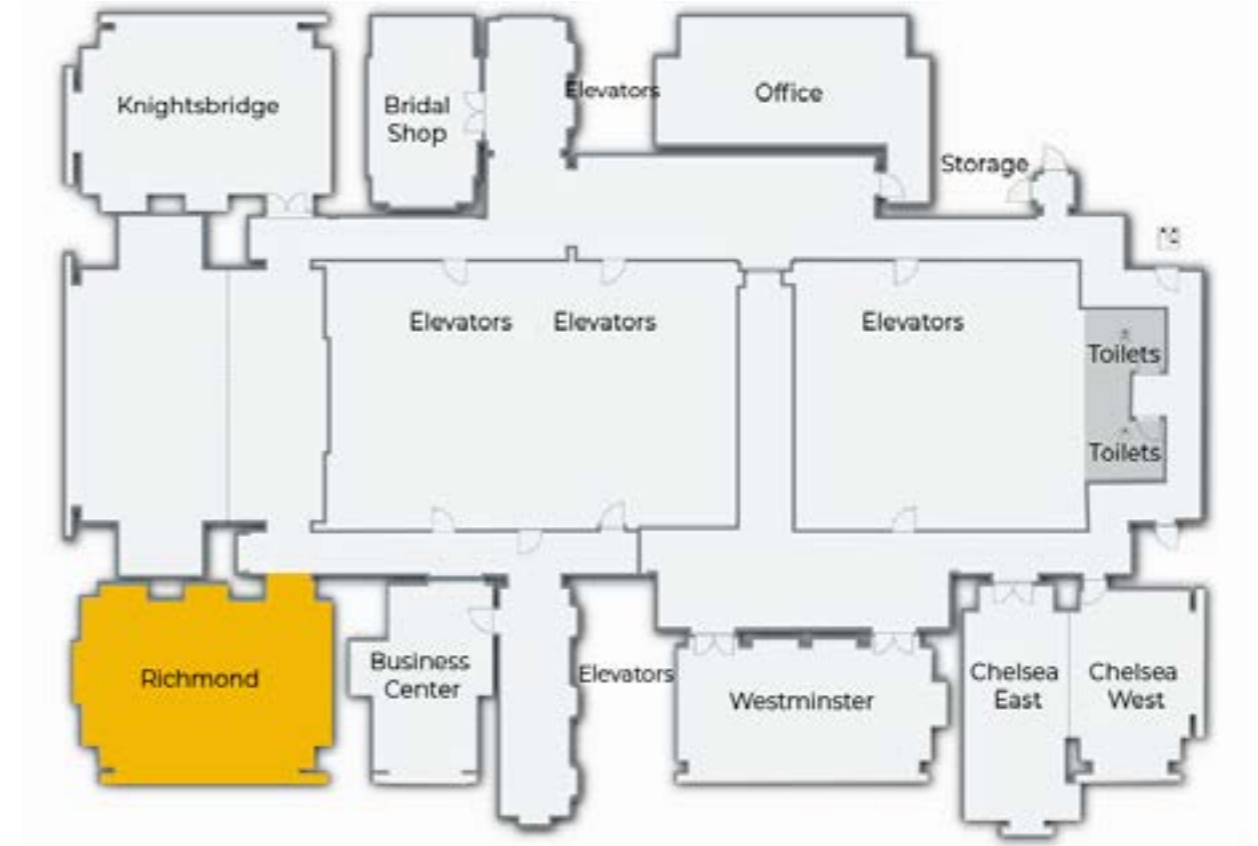

Key Contacts



Blair Lucas

Sales Director - Asia

✉ blucas@rpmglobal.com

[Connect on LinkedIn](#)



Ian Sedgwick

Senior Solutions Executive

✉ iansedgwick@rpmglobal.com

[Connect on LinkedIn](#)



Rulli Rachman

Technical Advisor

✉ rrachman@rpmglobal.com

[Connect on LinkedIn](#)



Andiyoga Baskara

Asset Management Consultant

✉ abaskara@rpmglobal.com

[Connect on LinkedIn](#)

Competition Time

Kahoot:

Download or access at kahoot.it to win great prizes!

Kahoot!

[Play from Browser](#)

[Download on Apple Store](#)

[Download on Google Play](#)



LinkedIn Competition:

We are excited to give you an opportunity to win an Apple Watch with our LinkedIn Competition:

1. Snap an eye-catching photo during the event
2. Craft a compelling caption to accompany your photo
3. Mention RPMGlobal in your post
4. Share your post with your network

The winner will be revealed on August 30th. To win, ensure your photo garners the highest number of likes by capturing and sharing the standout moments from the event.

RPMGlobal Experience Centre Competition:

Be sure to visit our product booths to get your activity card stamped for your entry into the Major Door Prize. Details on this can be found on page 9.

Main Agenda | Richmond Room

9:00am **Dynamic Life Cycle Costing**
Andiyoga Baskara - Asset Management Consultant
Join us as we showcase how AMT provides accurate life-cycle positions and optimises maintenance strategies using Dynamic Life Cycle Costing (DLCC).

9:45am **Integration with RPMGlobal Solutions**
Andiyoga Baskara - Asset Management Consultant
See the benefits of integrating AMT with our RPMGlobal solutions.

10:05am ◦ **Morning Tea** ◦
Served in the Connect Live Networking Area, Level 2.

10:35am **Maintenance Debt**
Ian Sedgwick - Senior Solutions Executive
Understand the impact of postponing your maintenance on your assets' life cycle and operational performance.

11:25am **Hidden Value**
Rulli Rachman - Technical Advisor
Join our team of asset management experts, as they share their tips and tricks.

12:00pm ◦ **Lunch** ◦
Served in the Connect Live Networking Area, Level 2.

Main Agenda | Richmond Room

1:00pm **Creating & Evaluating What-If Scenarios**
Ian Sedgwick - Senior Solutions Executive
Creating & Evaluating What-If Scenarios with AMT reports.

2:25pm ◦ **Afternoon Tea** ◦
Served in the Connect Live Networking Area, Level 2.

2:40pm **Reducing Working Capital and Downtime**
Rulli Rachman - Technical Advisor
How to use Long-term Planning to optimise component inventory and reduce asset downtime.

3:00pm **Inventory Optimisation**
Ian Sedgwick - Senior Solutions Executive
Learn how IMAFs can continuously improve the accuracy of parts availability, reduce inventories, decrease stockouts, and reduce equipment downtimes.

3:20pm **AMT Customer Success Stories**
Ian Sedgwick - Senior Solutions Executive
Real-world examples of customers who have used AMT to reduce downtime, increase efficiency, and save millions using AMT.

3:40pm **Latest AMT Release & AMT Roadmap**
Ian Sedgwick - Senior Solutions Executive
We share the recent enhancements to AMT and share the development roadmap, informed by industry challenges.

Main Agenda | Richmond Room

-
- 4:00pm **Closing Remarks / Q&A Time**
Andiyoga Baskara - Asset Management Consultant
Rulli Rachman - Technical Advisor
Closing address, and opportunity to ask any further questions.
-
- 4:10pm **◦ Networking Afternoon Coffee & Merchandise Collection ◦**
-
- 4:30pm **Door Prize Announcement**
Michael Baldwin | Regional General Manager - Asia Pacific
Join us, along with our Indonesia Connect Live event attendees, where you will enjoy an afternoon of refreshments and networking.
Don't forget to hand in your completed 'Experience Centre' Activity card for your entry into the Door Prize.
-

Experience Centre

We're excited to have you explore our 'RPMGlobal Experience Centre', where you'll have the opportunity to engage with our cutting-edge solutions first-hand and connect with our experts and product managers.

Here's how it works:

Visit our Product Booths: The Experience Centre features dedicated booths for each of our key solutions: AMT, MINEPLANNER, XECUTE, and RPM Connect. Each booth is designed to give you an in-depth look at our offerings and allow you to interact with our specialists.

Complete the Activities: At each booth, you'll find engaging activities that showcase the capabilities and benefits of our solutions. Participate in these activities to learn more and earn your stamps.

Get Your Activity Card Stamped: Collect a stamp on your activity card from each booth you visit. Make sure to complete all activities to qualify for the prize draw.

Enter the Prize Draw: Once you have all your stamps, drop your completed activity card into the prize draw box. The draw will take place during the afternoon networking session, where one lucky winner will be announced and awarded the major door prize!

We encourage you to take full advantage of this opportunity to explore our solutions and connect with our team. Enjoy the experience and good luck in the prize draw!

AMT Mobile:

- Complete a checklist in the AMT Mobile app.

MinePlanner:

- Perform a task in SDM
- Edit a strip line in MinePlanner - Steep Coal

XECUTE:

- Download the XECUTE Mobile app on your device.
- Create and schedule an activity area in XECUTE.

RPM Connect:

- Visit the RPM Connect Booth and successfully sign up to RPM Connect.

RPMGLOBAL
ASSET MANAGEMENT
MASTERCLASS

Learn more about our Solutions



rpmglobal.com/apacsolutions